

PROJECT:
5 CLASSROOM ADDITION
LOCATION:
WEST NAVARRE INTERMEDIATE
SCHOOL
1970 COTTON BAY LANE
NAVARRE, FL 32566

CONSULTANTS:

JEHLE-HALSTEAD INC.
5414 HIGHWAY 90
MILTON, FL 32571

CRAFT & WEBSTER
STRUCTURAL ENGINEERING, INC.
129 HIGHPOINT DRIVE
GULF BREEZE, FL 32561

GULF BREEZE CONSULTING, INC.
139 EAST GOVERNMENT STREET
PENSACOLA, FL 32502

ADAMS CONSULTING
ENGINEERING, INC.
3 WEST GARDEN STREET - SUITE 382
PENSACOLA, FL 32502



VICINITY MAP

SECTION 30 TOWNSHIP 1-N, RANGE 28-W



GENERAL NOTES

- ALL CONSTRUCTION SHALL BE COMPLETED IN ACCORDANCE WITH SECTION 423 OF THE FLORIDA BUILDING CODE, STATE REQUIREMENTS FOR EDUCATIONAL FACILITIES, LATEST EDITION AND ALL OTHER APPLICABLE CODES AND SPECIFICATIONS FOR BUILDING AND UTILITY INSTALLATION.
- IN CASE OF A DISCREPANCY ON THESE DRAWINGS OR BETWEEN THESE DRAWINGS AND THOSE OF ANY OTHER DISCIPLINE, THE MORE STRINGENT REQUIREMENT SHALL PREVAIL. REPORT ANY DISCREPANCY TO ARCHITECT PRIOR TO ACTION.
- SEE ARCHITECTURAL PLANS FOR BUILDING DIMENSIONS AND FOR DETAILS ON PROPOSED RAMPS AND STEPS. COORDINATE FENCING REQUIREMENTS WITH ARCHITECTURAL PLANS.
- THE CONTRACTOR SHALL BE RESPONSIBLE FOR SODDING ALL AREAS INDICATED ON THE PLANS AND ALL OTHER EXISTING SODDED AREAS WHICH ARE DISTURBED AS A RESULT OF CONSTRUCTION ACTIVITIES. WHETHER SUCH AREAS AND OR ACTIVITIES ARE INDICATED ON THE PLANS OR NOT. ALL DISTURBED AREAS NOT TO BE SODDED SHALL BE SEEDED AND MULCHED.
- ALL SITE DRAINAGE INCLUDING ROOF DRAINS, DOWN SPOUTS, AND GUTTERS ARE TO BE ROUTED TO CARRY ALL STORM WATER TO THE ADJACENT INLET SYSTEM.
- LOCATIONS AND ELEVATIONS OF UTILITIES SHOWN ON PLANS ARE TO BE CONSIDERED APPROXIMATE ONLY. THE CONTRACTOR SHALL EMPLOY THE USE OF GROUND PENETRATING RADAR (GPR) EQUIPMENT BY A QUALIFIED COMPANY AND PERSONNEL TO LOCATE, IDENTIFY AND PROTECT EXISTING UNDERGROUND UTILITIES IN THE AREA OF WORK. ANY UTILITIES SPOTTED SHALL BE DRAWN ON THE SITE PLAN PROVIDED BY THE ARCHITECT/ENGINEER AND SUBMITTED AS PART OF THE "AS-BUILT" DRAWINGS. COST OF GPR LOCATES SHALL BE INCLUDED IN THE CONTRACTORS BASE BID. NOTIFY UTILITY AND ARCHITECT/ENGINEER OF CONFLICTS BETWEEN EXISTING AND PROPOSED FACILITIES.
- NOTIFY SUNSHINE UTILITIES 48 HOURS IN ADVANCE PRIOR TO DIGGING WITHIN R/W; 1-800-432-4770.
- DAMAGE TO EXISTING SIDEWALKS DURING CONSTRUCTION WILL REQUIRE REPAIR AND/OR REPLACEMENT.
- THE CONTRACTOR SHALL COMPLY WITH ALL FEDERAL AND STATE REGULATIONS CONCERNING NOTIFICATION TO THE REGULATORY AUTHORITIES OF ANY AND ALL BUILDING RENOVATIONS AND/OR DEMOLITION.
- ALL ASPECTS OF THE STORMWATER/DRAINAGE COMPONENTS SHALL BE COMPLETED PRIOR TO FINAL ACCEPTANCE.
- THE CONTRACTOR SHALL BE RESPONSIBLE FOR NOTIFYING THE ENGINEER OF RECORD AT LEAST 72 HOURS PRIOR TO COMMENCEMENT AND COMPLETION OF CONSTRUCTION, CONSTRUCTION MONITORING AND SUPPLYING CLEAR & LEGIBLE REVISIONS TO THE CONSTRUCTION PLANS FOR USE DURING AS-BUILT CERTIFICATION.
- ENGINEER OF RECORD SHALL BE RESPONSIBLE FOR SUBMITTING, TO ALL APPROPRIATE PARTIES, NOTICE OF CONSTRUCTION COMMENCEMENT, COMPLETION AND AS-BUILT CERTIFICATION.
- CONTRACTOR SHALL BE RESPONSIBLE FOR ALL MAINTENANCE AND/OR EXPANSION OF EXISTING IRRIGATION SYSTEM SUCH THAT COVERAGE IS PROVIDED TO SODDED AREAS PER WRITTEN SPECIFICATIONS. CONTRACTOR IS RESPONSIBLE FOR HIS OWN INVESTIGATION OF THE EXACT CONDITIONS OF THE EXISTING SYSTEM PRIOR TO DISRUPTION, INCLUDING LOCATION OF HEADS, ZONES, TIMERS, CONTROL VALVES, ETC. SCHOOL DISTRICT PERSONNEL WILL BE MADE AVAILABLE FOR ASSISTANCE DURING THIS INVESTIGATION. CONTRACTOR SHALL SUBMIT, TO THE ARCHITECT, A PRE-WORK REPORT DETAILING HIS FINDINGS. FAILURE TO SUBMIT THIS REPORT WILL EQUAL AN ASSUMPTION OF A FULLY FUNCTIONAL SYSTEM, AND ANY PROBLEMS DISCOVERED DURING FINAL INSPECTION WILL BE CORRECTED AT THE CONTRACTOR'S EXPENSE.

LEGEND:

- x 38.52 SPOT ELEVATION
- DI #2 DROP INLET
- A/C AIR CONDITIONING
- TBM TEMPORARY BENCHMARK
- IR IRRIGATION BOX
- WATER METER
- EL ELECTRICAL BOX
- SC SEWER CLEANOUT
- PO POWER POLE
- SP SERVICE POLE
- GA GUY ANCHOR
- FD FIRE HYDRANT
- STOP SIGN
- NO PARKING SIGN
- IR IRON ROD
- LS LIFT STATION
- WV WATER VALVE

EXISTING STORMWATER INLETS

- | | | |
|---|---|---|
| DROP INLET #1
TOP ELEVATION = 38.89'
36" REINFORCED
CONCRETE PIPE
INVERT(E) = 33.60'
24" REINFORCED
CONCRETE PIPE
INVERT(S) = 33.57' | DROP INLET #2
TOP ELEVATION = 38.47'
36" REINFORCED
CONCRETE PIPE
INVERT(W) = 33.50'
INVERT(E) = 33.72'
24" REINFORCED
CONCRETE PIPE
INVERT(S) = 33.68' | DROP INLET #3
TOP ELEVATION = 38.32'
36" REINFORCED
CONCRETE PIPE
INVERT(W) = 33.34'
INVERT(E) = 33.35'
24" REINFORCED
CONCRETE PIPE
INVERT(S) = 33.47' |
| DROP INLET #4
TOP ELEVATION = 39.70'
36" REINFORCED
CONCRETE PIPE
INVERT(W) = 33.05'
INVERT(E) = 32.94'
24" REINFORCED
CONCRETE PIPE
INVERT(S) = 33.06' | DROP INLET #5
TOP ELEVATION = 39.79'
36" REINFORCED
CONCRETE PIPE
INVERT(W) = 32.80'
INVERT(E) = 32.58'
24" REINFORCED
CONCRETE PIPE
INVERT(S) = 32.99' | DROP INLET #6
TOP ELEVATION = 39.37'
24" REINFORCED
CONCRETE PIPE
INVERT(N) = 35.72' |
| | | DROP INLET #7
TOP ELEVATION = 39.23'
24" REINFORCED
CONCRETE PIPE
INVERT(N) = 35.54' |

SITE DEMOLITION PLAN

30' 15' 0' 30' 60'

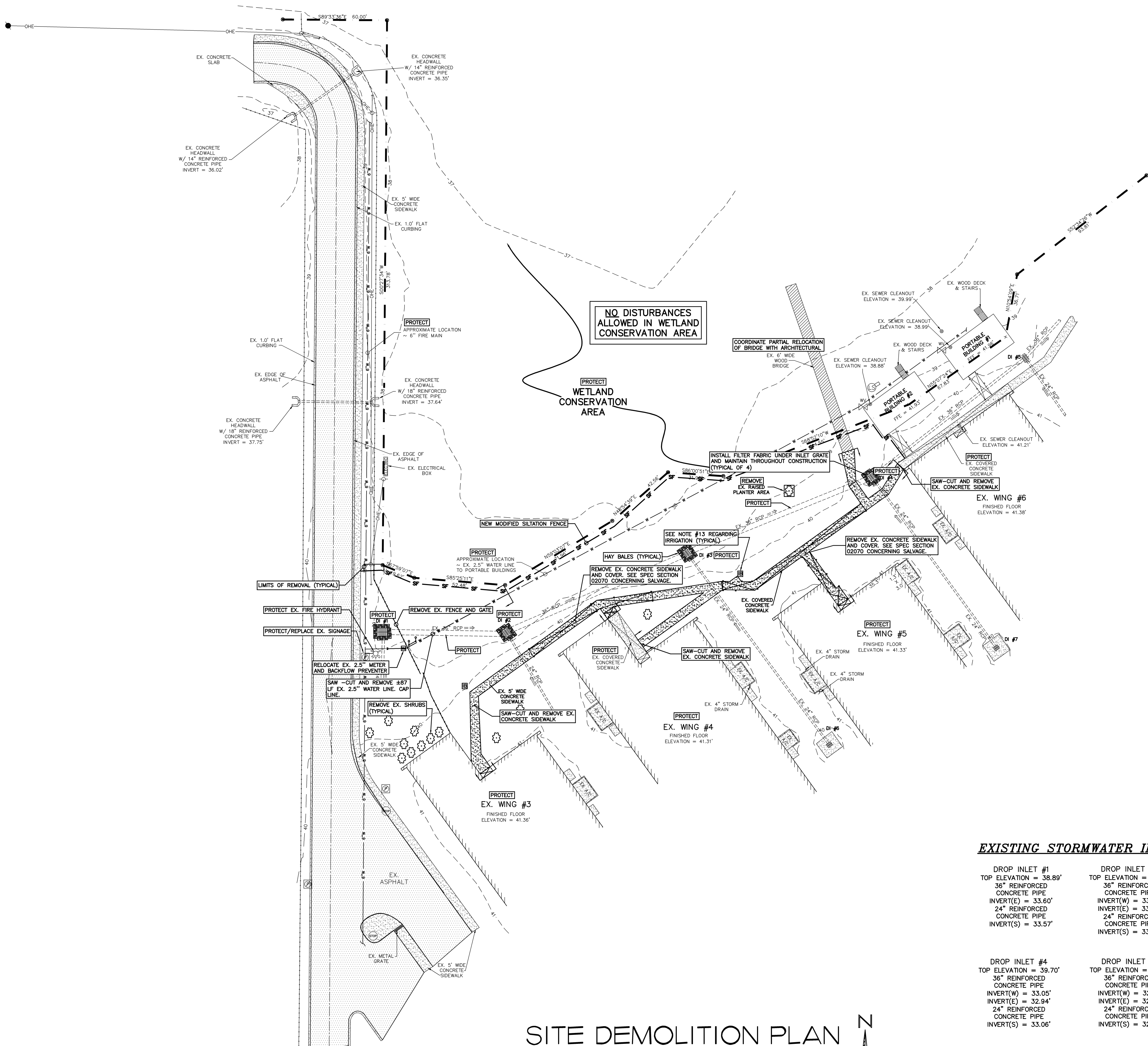

NEW CLASSROOM ADDITIONS

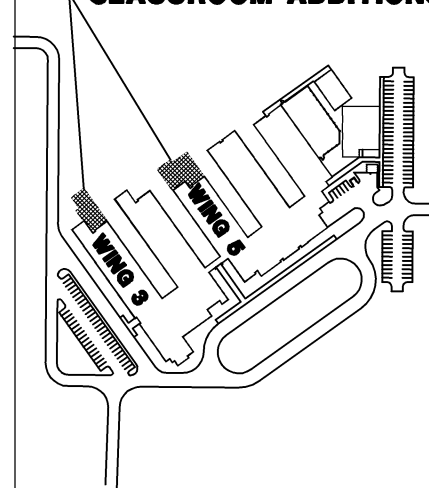

WEST NAVARRE INTERMEDIATE

No.	Revision/Issue	Date

D. PATRICK JEHL, JR.
P.E. 71528

DRAWN BY: WEB
CHECKED BY: DPJ
PROJECT #: 21118.03
REVIEW: 09-06-11
PERMITTING: 09-09-11
RELEASE FOR BIDDING: 09-19-11

CIVIL
SITE
DEMOLITION
PLAN

C-001

PROJECT:
5 CLASSROOM ADDITION
LOCATION:
WEST NAVARRE INTERMEDIATE
SCHOOL
1970 COTTON BAY LANE
NAVARRE, FL 32566

CONSULTANTS:
JEHLE-HALSTEAD INC.
5414 HIGHWAY 90
MILTON, FL 32571
CRAFT & WEBSTER
STRUCTURAL ENGINEERING, INC.
129 HIGHPOINT DRIVE
GULF BREEZE, FL 32561
GULF BREEZE CONSULTING, INC.
139 EAST GOVERNMENT STREET
PENSACOLA, FL 32502
ADAMS CONSULTING
ENGINEERING, INC.
3 WEST GARDEN STREET - SUITE 382
PENSACOLA, FL 32502

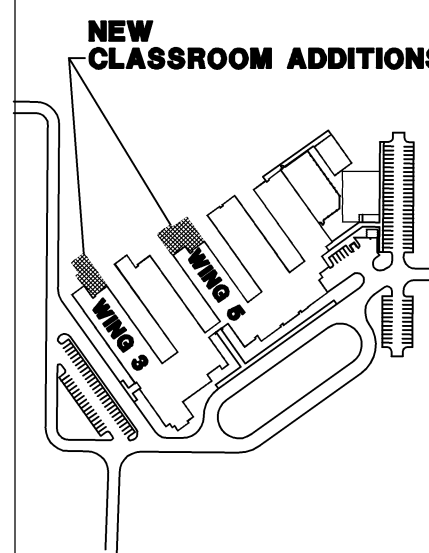

No.	Revision/Issue	Date

D. PATRICK JEHL, JR.
P.E. 71528

DRAWN BY: WEB
CHECKED BY: DPJ
PROJECT #: 21118.03
REVIEW: 09-06-11
PERMITTING: 09-09-11
RELEASE FOR BIDDING: 09-19-11

CIVIL
SITE
PLAN

C-002

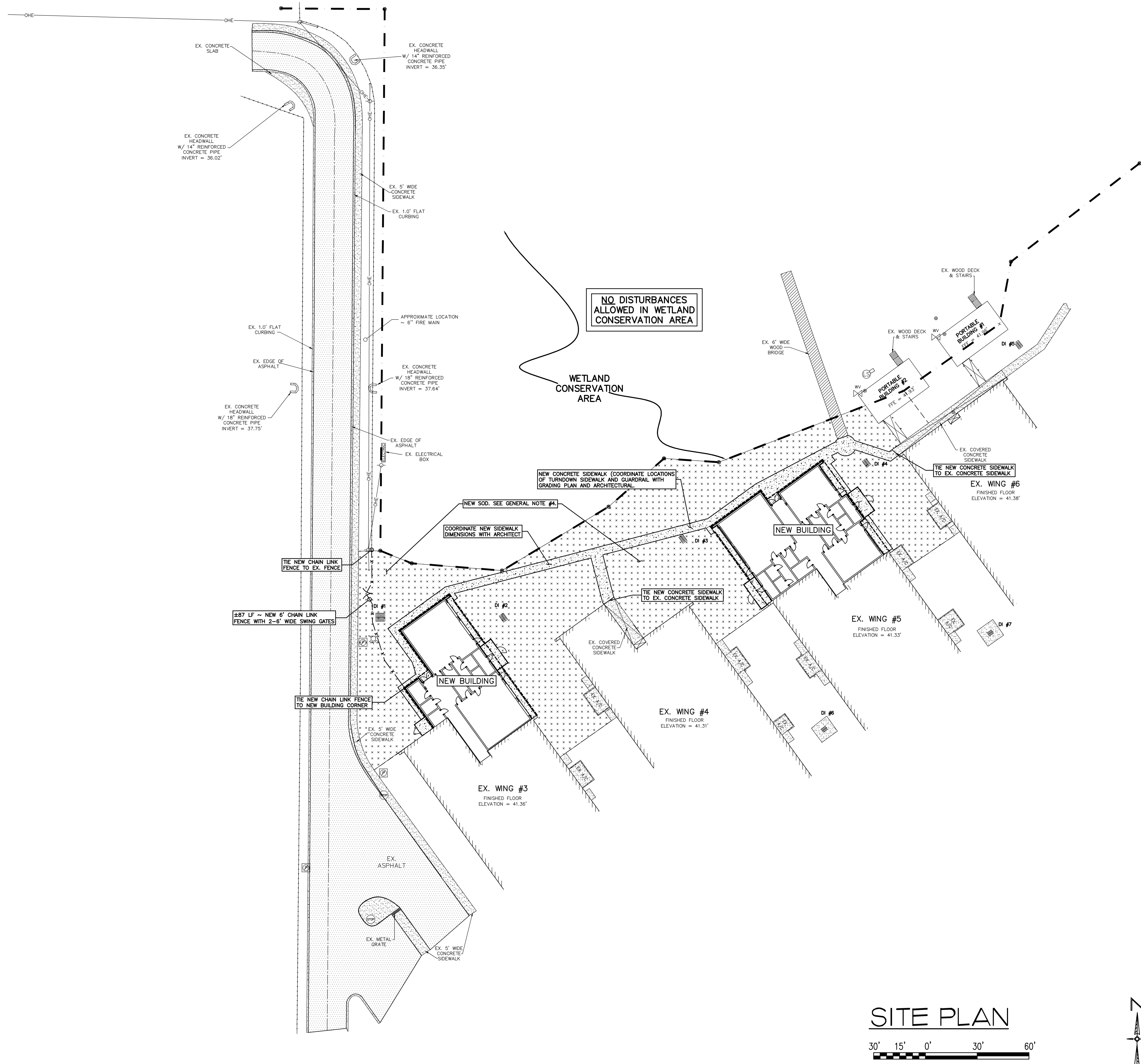

SITE DATA

PROP. REF. NO.	23-2S-27-0000-02604-0000 (EX. WING #3) 23-2S-27-0000-02684-0000 (EX. WING #5)
STREET ADDRESS	1970 COTTON BAY LANE NAVARRE, FLORIDA 32566
ZONING	02604 - R1M, HCD 02684 - R1A, R1M, HCD, PBD
FUTURE LAND USE	02604 - SFR, COMM 02684 - SFR, COMM, MRC
BUILDING SETBACKS	02064 - 25' FRONT, 25' REAR, 7' SIDE 02684 - 20' FRONT, 10' REAR, 7' SIDE
PARENT PARCEL AREA PROJECT AREA	22.7 ACRE - 7.23 (02604) + 15.47 (02684) ±0.7 ACRE
BUILDING USE BUILDING AREA	PUBLIC SCHOOL ±7,500 SF PROPOSED

LEGEND:

x 38.52	SPOT ELEVATION
DI #2	DROP INLET
A/C	AIR CONDITIONING
TBM	TEMPORARY BENCHMARK
IR	IRRIGATION BOX
WM	WATER METER
EB	ELECTRICAL BOX
SC	SEWER CLEANOUT
PP	POWER POLE
SP	SERVICE POLE
GA	GUY ANCHOR
FH	FIRE HYDRANT
SS	STOP SIGN
NPS	NO PARKING SIGN
IR	IRON ROD
LS	LIFT STATION
WV	WATER VALVE

PROJECT:
5 CLASSROOM ADDITION

LOCATION:
WEST NAVARRE INTERMEDIATE
SCHOOL
1970 COTTON BAY LANE
NAVARRE, FL 32566

CONSULTANTS:
JEHLE-HALSTEAD INC.
5414 HIGHWAY 90
MILTON, FL 32571

CRAFT & WEBSTER
STRUCTURAL ENGINEERING, INC.
129 HIGHPOINT DRIVE
GULF BREEZE, FL 32561

GULF BREEZE CONSULTING, INC.
139 EAST GOVERNMENT STREET
PENSACOLA, FL 32502

ADAMS CONSULTING
ENGINEERING, INC.
3 WEST GARDEN STREET - SUITE 382
PENSACOLA, FL 32502

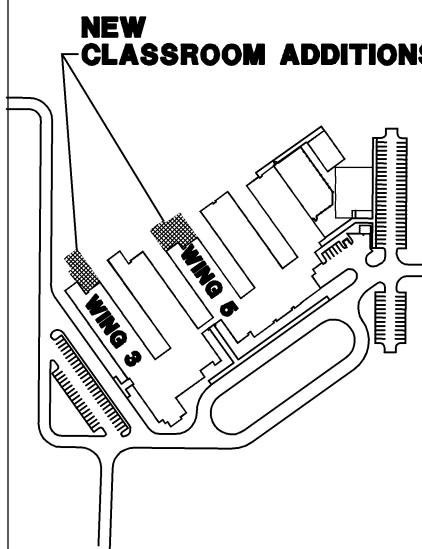

WEST NAVARRE
INTERMEDIATE

No.	Revision/Issue	Date

D. PATRICK JEHL, JR.
P.E. 71528

DRAWN BY: WEB
CHECKED BY: DPJ
PROJECT #: 21118.03
PINDER-MARTIN ASSOCIATES, INC.
REVIEW: 09-06-11
PERMITTING: 09-09-11
RELEASE FOR BIDDING: 09-19-11

CIVIL
SITE
GRADING
PLAN

C-003

GENERAL NOTES:

- 1) SOUTHERN SURVEYING, INC., HAS MADE NO INVESTIGATION OR INDEPENDENT SEARCH FOR EASEMENTS OF RECORD, ENCUMBRANCES, RESTRICTIVE COVENANTS OR ANY UNDERGROUND IMPROVEMENTS THAT MIGHT EXIST. VISIBLE EVIDENCE OF EASEMENTS WILL BE SHOWN HEREON.
- 2) MEASUREMENTS ARE MADE TO U.S. STANDARDS.
- 3) PROPERTY IS SUBJECT TO ZONING SETBACKS AND RESTRICTIONS OF RECORD.
- 4) THE ACCURACY OF MEASUREMENTS PERFORMED MEETS THE RELATIVE ERROR OF CLOSURE PERMISSIBLE IN A SUBURBAN LAND AREA.
- 5) NOTICE: THERE MAY BE ADDITIONAL RESTRICTIONS THAT ARE NOT RECORDED ON THIS SURVEY THAT MAY BE FOUND IN THE PUBLIC RECORDS OF THIS COUNTY.
- 6) THE VERTICAL CONTROL SHOWN HEREON IS BASED ON A UNITED STATES COAST AND GEODETIC SURVEY BENCHMARK STAMPED K 26 RESET 1963 WITH AN ELEVATION OF 26.07 FEET. (NAVD 88)

TBM 1306/61 MADE "X" CUT IN THE NORTHWEST CORNER OF A CONCRETE DROP INLET, LOCATED 15.3 FEET EAST AND 13.5 FEET NORTH OF THE NORTHEAST BUILDING CORNER OF BUILDING #1. ELEVATION = 39.80 FEET

TBM 1306/62 MADE "X" CUT IN THE NORTH BONNETT BOLT OF A FIRE HYDRANT. LOCATED 65 FEET NORTH AND 27.5 FEET EAST OF THE NORTHWEST BUILDING CORNER OF BUILDING #4. ELEVATION = 41.64 FEET

- 7) THE LOCATION OF UNDERGROUND UTILITIES AS SHOWN HEREON ARE BASED ON ABOVE GROUND FIELD EVIDENCE OR INFORMATION SUPPLIED BY SAID UTILITY ONLY, THERE MAY BE OTHER UTILITIES NOT KNOWN TO US THAT SHOULD BE VERIFIED BY CLIENT.
- 8) IF THE HORIZONTAL AND VERTICAL CONTROL SHOWN HEREON IS TO BE USED FOR CONSTRUCTION PURPOSES, THEN ALL HORIZONTAL AND VERTICAL CONTROL SHALL BE FIELD VERIFIED FOR CORRECTNESS BEFORE THE START OF SAID CONSTRUCTION ACTIVITIES.

LEGAL DESCRIPTION

COM NW COR SEC TH N 89°09'25" E
408.51 FT TO POB TH CONT 682.89 FT TH
S 0°26'23" W 2338.57 FT TH N 89° 33'26"
W 683.40 FT TH N 0°27'2 4" E 2323.25
FT TO POB AS DES IN OR 1664 PG 394 &
OR 1684 PG 1022

LEGEND:

- x 38.52 SPOT ELEVATION
- DI #2 DROP INLET
- A/C AIR CONDITIONING
- TBM TEMPORARY BENCHMARK
- IRRIGATION BOX
- WATER METER
- ELECTRICAL BOX
- SEWER CLEANOUT
- POWER POLE
- SERVICE POLE
- GUY ANCHOR
- FIRE HYDRANT
- STOP SIGN
- NO PARKING SIGN
- IRON ROD
- LIFT STATION
- WV WATER VALVE

SITE GRADING PLAN

30' 15' 0' 30' 60'



PROJECT:
5 CLASSROOM ADDITION

LOCATION:
WEST NAVARRE INTERMEDIATE
SCHOOL
1970 COTTON BAY LANE
NAVARRE, FL 32566

CONSULTANTS:

JEHLE-HALSTEAD INC.
5414 HIGHWAY 90
MILTON, FL 32571

CRAFT & WEBSTER
STRUCTURAL ENGINEERING, INC.
129 HIGHPOINT DRIVE
GULF BREEZE, FL 32561

GULF BREEZE CONSULTING, INC.
139 EAST GOVERNMENT STREET
PENSACOLA, FL 32502

ADAMS CONSULTING
ENGINEERING, INC.
3 WEST GARDEN STREET - SUITE 382
PENSACOLA, FL 32502

NEW
CLASSROOM ADDITIONS

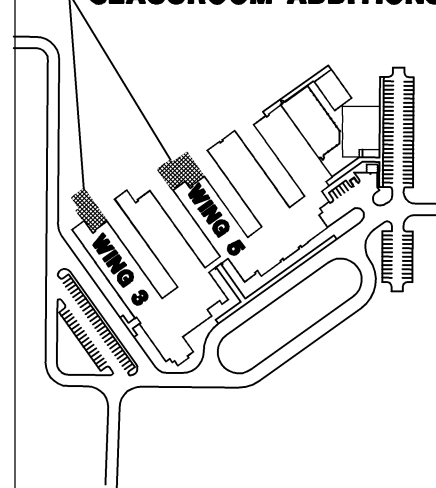

WEST NAVARRE
INTERMEDIATE

No.	Revision/Issue	Date

EXISTING STORMWATER INLETS

DROP INLET #1 TOP ELEVATION = 38.89' 36" REINFORCED CONCRETE PIPE INVERT(E) = 33.60' 24" REINFORCED CONCRETE PIPE INVERT(S) = 33.57'	DROP INLET #2 TOP ELEVATION = 38.47' 36" REINFORCED CONCRETE PIPE INVERT(W) = 33.50' INVERT(E) = 33.72' 24" REINFORCED CONCRETE PIPE INVERT(S) = 33.68'	DROP INLET #3 TOP ELEVATION = 38.32' 36" REINFORCED CONCRETE PIPE INVERT(W) = 33.34' INVERT(E) = 33.35' 24" REINFORCED CONCRETE PIPE INVERT(S) = 33.47'
DROP INLET #4 TOP ELEVATION = 39.70' 36" REINFORCED CONCRETE PIPE INVERT(W) = 33.05' INVERT(E) = 32.94' 24" REINFORCED CONCRETE PIPE INVERT(S) = 33.06'	DROP INLET #5 TOP ELEVATION = 39.79' 36" REINFORCED CONCRETE PIPE INVERT(W) = 32.80' INVERT(E) = 32.58' 24" REINFORCED CONCRETE PIPE INVERT(S) = 32.99'	DROP INLET #6 TOP ELEVATION = 39.37' 24" REINFORCED CONCRETE PIPE INVERT(N) = 35.72'
		DROP INLET #7 TOP ELEVATION = 39.23' 24" REINFORCED CONCRETE PIPE INVERT(N) = 35.54'

LEGEND:

x 38.52	SPOT ELEVATION
DI #2	DROP INLET
A/C	AIR CONDITIONING
TBM	TEMPORARY BENCHMARK
IB	IRRIGATION BOX
WM	WATER METER
EB	ELECTRICAL BOX
SC	SEWER CLEANOUT
PP	POWER POLE
SP	SERVICE POLE
GA	GUY ANCHOR
FH	FIRE HYDRANT
SS	STOP SIGN
NP	NO PARKING SIGN
IR	IRON ROD
LS	LIFT STATION
WV	WATER VALVE

D. PATRICK JEHL, JR.
P.E. 71528

DRAWN BY: WEB
CHECKED BY: DPJ

PINDER-MARTIN ASSOCIATES, INC.
PROJECT #: 21118.03
REVIEW: 09-06-11
PERMITTING: 09-09-11
RELEASE FOR BIDDING: 09-19-11

CIVIL
SITE
UTILITY
PLAN

C-004

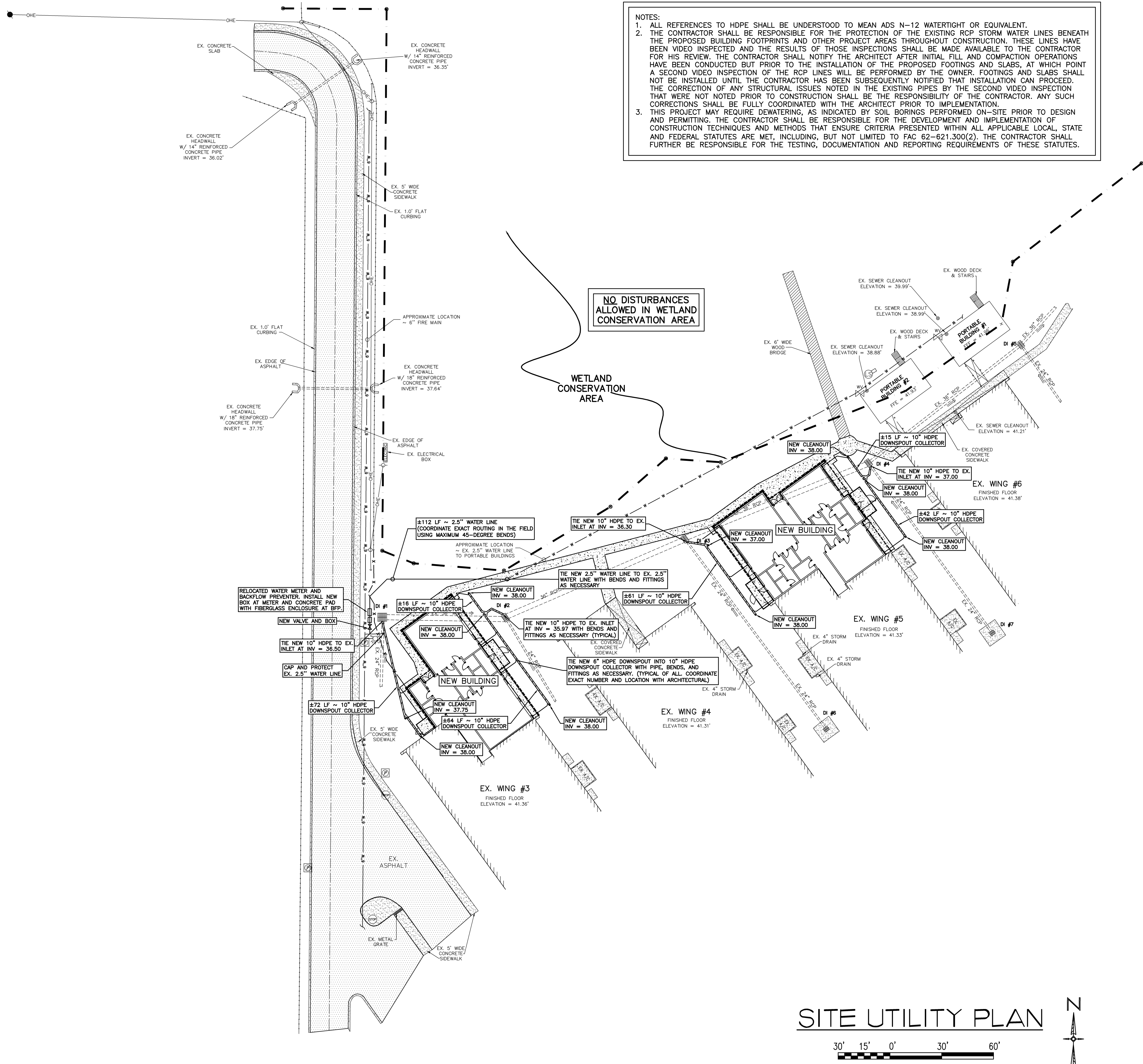

1. CONTRACTOR SHALL BE RESPONSIBLE FOR THE INSTALLATION (PRIOR TO CONSTRUCTION) AND MAINTENANCE/REPAIRS OF (DURING CONSTRUCTION) EROSION CONTROL MEASURES. EROSION CONTROL MEASURES TO RETAIN ALL SEDIMENT AND EROSION ON THE SITE OF DEVELOPMENT. THE PROVISIONS SHOWN HEREIN REPRESENT THE MINIMUM EROSION CONTROL MEASURES TO BE USED.
2. ALL SOIL WASHED, DROPPED, SPILLED, OR TRACKED OUTSIDE THE SITE OR INTO PUBLIC RIGHTS-OF-WAY WILL BE REMOVED IMMEDIATELY.
3. ALL EROSION CONTROL MEASURES SHALL BE TREATED AS APPROPRIATE TO PREVENT THE GENERATION OF DUST.
4. AT THE TIME OF SITE PREPARATION FOR PERMANENT VEGETATIVE STABILIZATION AND RESTORATION, ALL EROSION CONTROL MEASURES IN THE ENVIRONMENT TO SUPPORT PERMANENT COVER SHALL BE REMOVED OR ENCLOSED IN SUCH A WAY THAT WILL PERMANENTLY ADJUST THE SOIL CONDITIONS AND RENDER IT SUITABLE FOR PERMANENT COVER. THE SOIL CONDITIONS AND TREATMENT OF EROSION CONTROL MEASURES IN UNDESIRABLE CONDITIONS, NON-VEGETATIVE MEANS OF PERMANENT GROUND STABILIZATION SHALL BE EMPLOYED (I.E. EROSION CONTROL FABRIC, CONCRETE, ETC.).
5. THE CONTRACTOR SHALL MAKE REGULAR INSPECTIONS OF ALL CONTROL MEASURES THROUGHOUT THE CONSTRUCTION PROCESS TO ENSURE THE OVERALL EFFECTIVENESS. THE EROSION AND SEDIMENT CONTROL PLAN, PERMITS, AND INSPECTIONS SHALL BE REVIEWED BY THE PROJECT MANAGER AND WITHIN TWENTY-FOUR (24) HOURS OF THE END OF A STORM EVENT THAT IS ONE (1) (0.50) INCH OR GREATER. ALL INSPECTIONS MUST BE REPORTED TO THE PROJECT MANAGER IMMEDIATELY AFTER EACH RAIN EVENT. IN THE EVENT THAT AN ON-SITE INSPECTION BY ANY PARTY REVEALS A DEFICIENCY IN THE INSTALLATION AND/OR MAINTENANCE OF EROSION AND SEDIMENT CONTROL MEASURES, THE CONTRACTOR SHALL BE RESPONSIBLE FOR IMMEDIATE CORRECTION.
6. FAILURE TO COMPLY WITH THE REQUIRED EROSION AND SEDIMENT CONTROL GUIDELINES MAY RESULT IN FINES LEVIED BY GOVERNMENTAL AGENCIES. FAILURE TO COMPLY WITH THE NON-COMPLIANCE SHALL BECOME THE RESPONSIBILITY OF THE CONTRACTOR.

1. PRIOR TO ANY SOIL DISTURBANCE, SILT FENCE SHALL BE INSTALLED ALONG ENTIRE DOWN-GRADE PERIMETER OF PROJECT AREA, AS SHOWN IN PLANS AND DETAILS, OR BY EQUIVALENT MEASURES. SILT FENCE SHALL REMAIN IN PLACE UNTIL ALL UP-GRADE AREAS OF DISTURBANCE HAVE BEEN PERMANENTLY STABILIZED.
2. A PROPER CONSTRUCTION ENTRANCE SHALL BE ESTABLISHED AT ALL POINTS OF INGRESS/EGRESS FROM CONSTRUCTION SITE, PER DETAIL PROVIDED IN THE PLANS, OR BY EQUIVALENT MEASURES. ALL CONSTRUCTION ENTRANCES SHALL REMAIN IN PLACE UNTIL INGRESS/EGRESS FROM THE SITE AT THAT POINT HAS STOPPED.

1. ALL DISTURBED AREAS THAT WILL BE LEFT EXPOSED FOR MORE THAN FOURTEEN (14) DAYS, AND ARE NOT SUBJECT TO CONSTRUCTION TRAFFIC, SHALL BE COVERED WITH MULCH OR STRAW, OR EQUIVALENT, IMMEDIATELY IF THE SEASON PREVENTS ESTABLISHMENT OF A TEMPORARY COVER. THE DISTURBED AREA WILL BE MULCHED WITH STRAW, OR EQUIVALENT, IMMEDIATELY, AT A MINIMUM, OF ONE (1) TON PER ACRE.
2. ALL DISTURBED AREAS THAT ARE SUBJECT TO HIGH AMOUNTS OF EROSION (I.E. STEEP SLOPES, EMBANKMENTS GREATER THAN 3:1, OR OTHER AS DICTATED BY SITE CONDITIONS) SHALL IMMEDIATELY RECEIVE A TEMPORARY COVER. THE COVER SHALL BE COMPOSED OF A MINIMUM OF ONE (1) TON OF MULCH MATERIAL, AT A THICKNESS OF TWO (2) TO FOUR (4) INCHES MIXED WITH THE TOP TWO (2) INCHES OF SOIL.
3. ALL DISTURBED AREAS SHALL BE COVERED WITH A MINIMUM OF MULCH BY WATER TO MINIMIZE THE GENERATION OF DUST.

1. THE SITE SHALL, AT ALL TIMES, BE GRADED AND MAINTAINED SUCH THAT ALL STORM WATER RUNOFF IS CONTROLLED BY EROSION AND SEDIMENT CONTROL MEASURES.
2. ALL AREAS USED FOR MATERIAL STOCKPILE, BE IT FILL/EXCAVATED MATERIALS, STONE, OR OTHERWISE, ARE TO BE STABILIZED, AND SHALL HAVE SILT FENCE WITH HAY BALES INSTALLED PER THE DETAILS PROVIDED IN THE PLANS, OR BY EQUIVALENT MEASURES, AROUND THEIR ENTIRE PERIMETER.

1. TEMPORARY OUTLET PROTECTION MUST BE INSTALLED AT ALL PROPOSED STORMWATER OUTFALLS PRIOR TO THE INSTALLATION OF THE DRAINAGE SYSTEM.
2. ALL THE DRAINAGE, INCLUDING ROOF DRAINS, DOWN SPOUTS, GUTTERS, OR OTHERWISE SHALL BE ROUTED TO CARRY ALL STORM WATER TO THE PROPOSED STORMWATER MANAGEMENT SYSTEM(S).
3. ANY SLOPES GREATER THAN 3:1 (H:V) RECEIVING PIPELINE OR UTILITY INSTALLATION SHALL BE BACKFILLED AND STABILIZED DAILY AS THE INSTALLATION PROCEEDS.

1. PERMANENT VEGETATION (I.E. SEED AND MULCH, SOD, ETC) TO BE INSTALLED ON ALL EXPOSED AREAS WITHIN TEN (10) DAYS AFTER FINAL GRADING.
2. UPON COMPLETION OF CONSTRUCTION, BUT PRIOR TO FINAL ACCEPTANCE, ALL CONSTRUCTION WASTE AND DEBRIS SHALL BE REMOVED FROM THE SITE AND ALL PAVED ROADWAYS AND/OR PARKING AREAS SHALL BE SWEEP CLEAN OF ALL SEDIMENT.
3. TEMPORARY EROSION AND SEDIMENT CONTROL MEASURES SHALL REMAIN IN PLACE AND BE MAINTAINED UNTIL SUCH TIME WHEN ALL UP-GRADE AREAS HAVE BEEN PERMANENTLY STABILIZED.

0 - 2 DAYS	~ SITE PREPARATION AND STABILIZED CONSTRUCTION ENTRANCE
3 - 4 DAYS	~ INSTALL PERIMETER SEDIMENT AND EROSION CONTROLS
5 - 10 DAYS	~ CLEARING/GRUBBING
11 - 20 DAYS	~ SITE GRADING
21 - 40 DAYS	~ INSTALL STORM SEWER AND UTILITIES
41 - 60 DAYS	~ CONCRETE SLAB
61 - 120 DAYS	~ FRAME STRUCTURE
121 - 170 DAYS	~ FINISH BUILDING, TURNLANES
171 - 180 DAYS	~ STABILIZE SITE

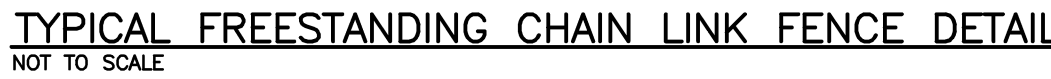

NOTE:
HAYBALES SHALL BE PLACED AT COMMENCEMENT OF CONSTRUCTION AND MAINTAINED THROUGHOUT PROJECT COMPLETION AND STABILIZATION IN ACCORDANCE WITH F.D.O.T. AND COUNTY STANDARDS WHERE APPLICABLE.

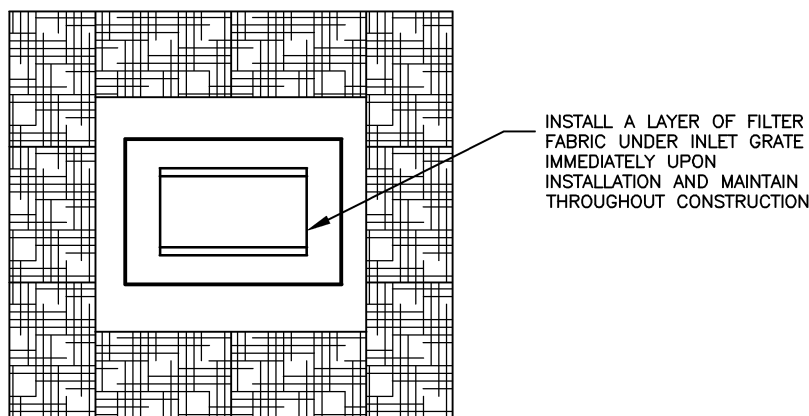

DITCH BOTTOM INLET
PROTECTION AROUND INLETS
OR SIMILAR STRUCTURES
NOT TO SCALE

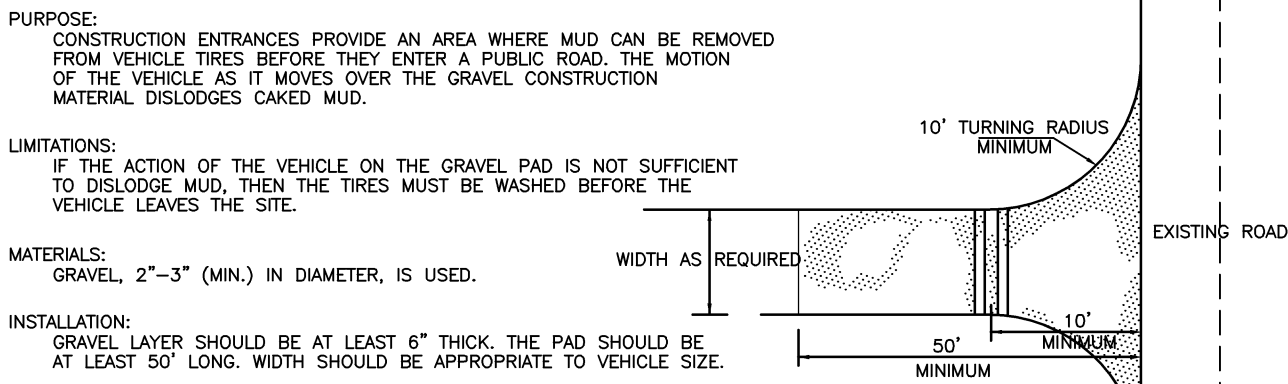

CONSTRUCTION ENTRANCE/EXIT
PLAN VIEW

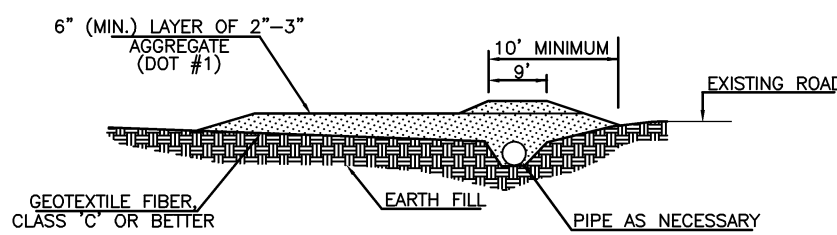

CONSTRUCTION ENTRANCE/EXIT
SECTION VIEW

CONSTRUCTION ENTRANCE/EXIT
NOT TO SCALE

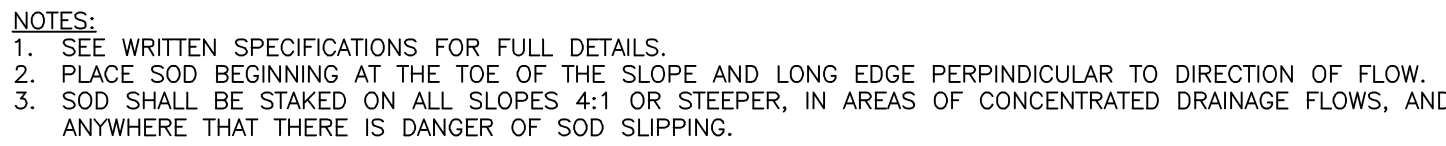

NOT TO SCALE

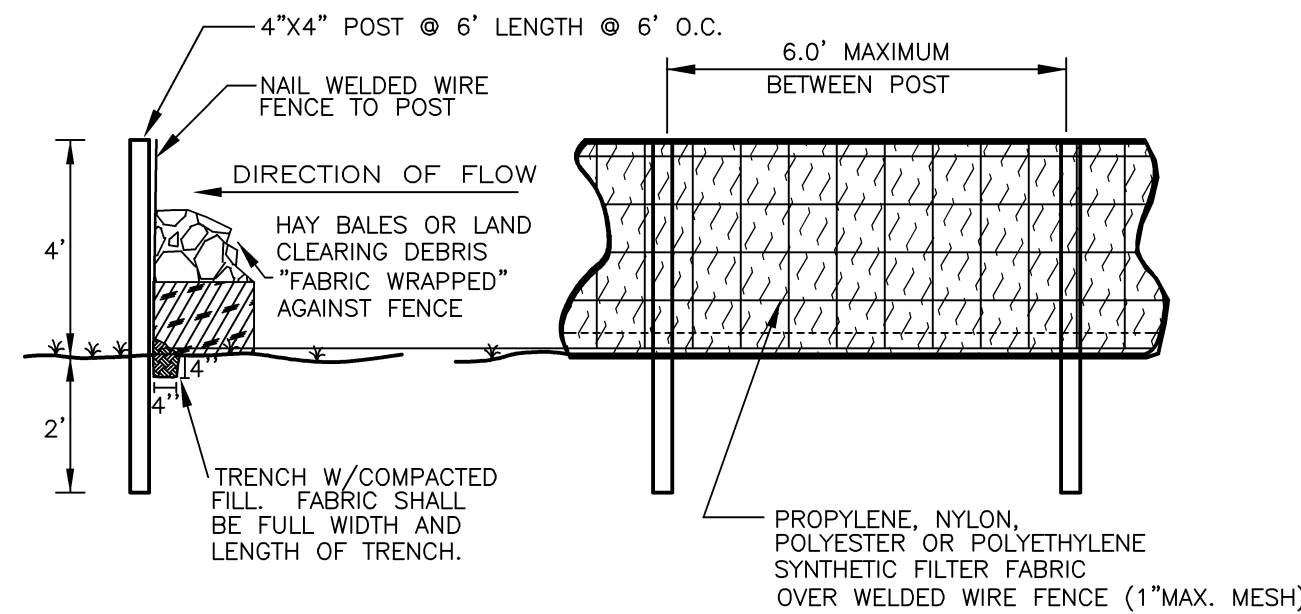

FENCE SECTION FENCE ELEVATION
MODIFIED SILTATION FENCE DETAIL
 NOT TO SCALE (DITCH CHECKS)

NOTES:
1. SILTATION FENCE TO BE CONSTRUCTED TO LIMITS SHOWN PRIOR TO ANY OTHER SITE DEVELOPMENT.
2. CONTRACTOR SHALL PERIODICALLY INSPECT FENCE LINE FOR SEDIMENT BUILD-UP. REMOVE SEDIMENT TO MAINTAIN MINIMUM 2' CLEAR FENCE FROM TOP (i.e. NO MORE THAN 2' SEDIMENT BUILD-UP).

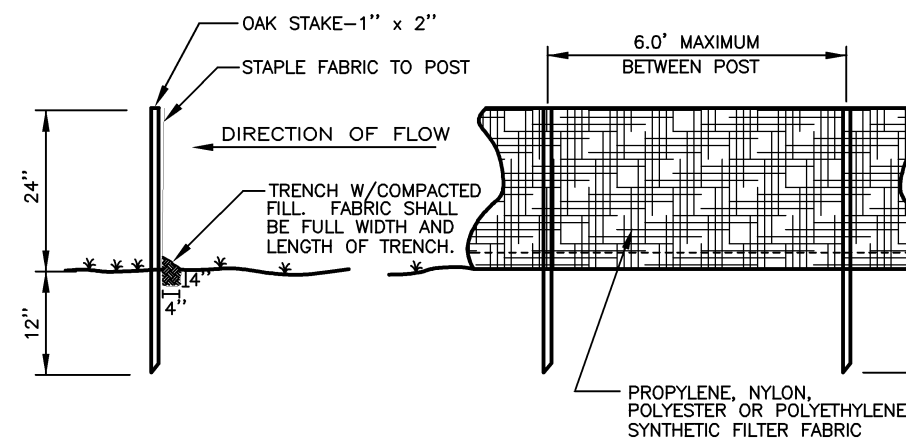

SILTATION FENCE DETAIL
NOT TO SCALE

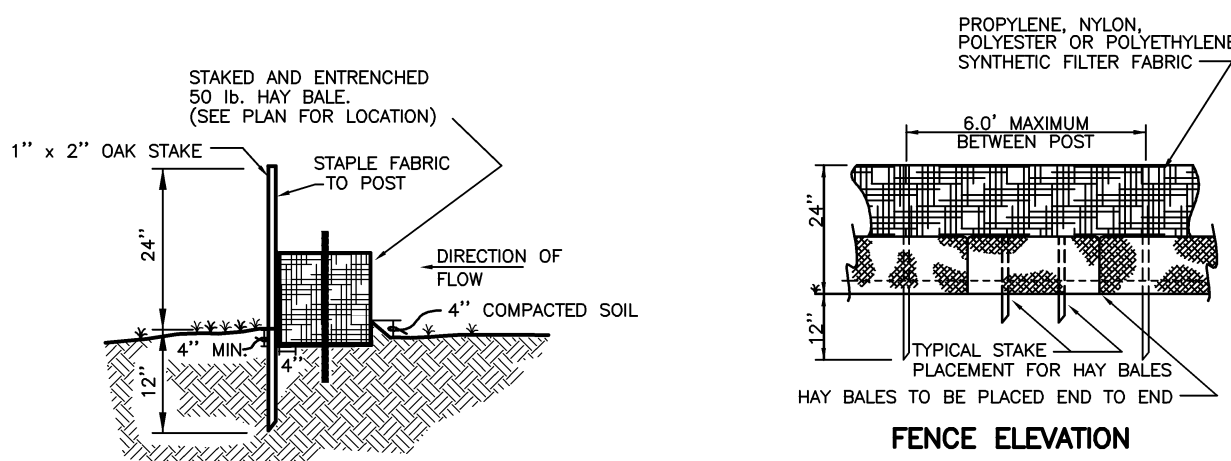

NOTE:
ANCHOR HAY BALES WITH
2"x2" STAKES - 2 PER BALE (TYP)

SILTATION FENCE DETAIL
WITH HAY BALES
NOT TO SCALE

AA26000896

LOCATION:
WEST NAVARRE INTERMEDIATE
SCHOOL
1970 COTTON BAY LANE
NAVARRE, FL 32566

JEHLE-HALSTEAD INC.
5414 HIGHWAY 90
MILTON, FL 32571

CRAFT & WEBSTER
STRUCTURAL ENGINEERING, INC.
129 HIGHPOINT DRIVE
GULF BREEZE, FL 32561

GULF BREEZE CONSULTING, INC.
139 EAST GOVERNMENT STREET
PENSACOLA, FL 32502

**ADAMS CONSULTING
ENGINEERING, INC.**
3 WEST GARDEN STREET — SUITE 382
PENSACOLA, FL 32502

NEW CLASSROOM ADDITIONS

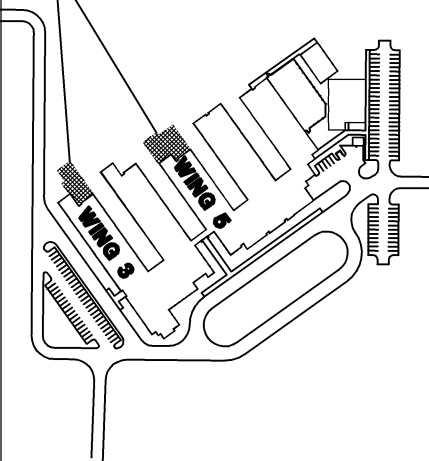
**WEST NAVARRE
INTERMEDIATE**[illegible]

D. PATRICK JEHL, JR
P.E. 71528

DRAWN BY:	WEB
CHECKED BY:	DPJj
PINDER-MARTIN ASSOCIATES, INC.	
PROJECT #:	21118.
REVIEW:	09-06-
PERMITTING:	09-09-
RELEASE FOR BIDDING:	09-19-

CIVIL SITE
EROSION
CONTROL
PLAN

C-0005

CONSULTANTS:
JEHLE-HALSTEAD INC.
5414 HIGHWAY 90
MILTON, FL 32571

CRAFT & WEBSTER
STRUCTURAL ENGINEERING, INC.
129 HIGHPOINT DRIVE
GULF BREEZE, FL 32561

GULF BREEZE CONSULTING, INC.
139 EAST GOVERNMENT STREET
PENSACOLA, FL 32502

ADAMS CONSULTING
ENGINEERING, INC.
3 WEST GARDEN STREET - SUITE 382
PENSACOLA, FL 32502

[illegible]

DRAWN BY:	WEB
CHECKED BY:	DPJj
PINDER-MARTIN ASSOCIATES, INC.	
PROJECT #:	21118.03
REVIEW:	09-06-11
PERMITTING:	09-09-11
RELEASE FOR BIDDING:	09-19-11

C-006

ini-110048C

TYPICAL FIBERGLASS ENCLOSURE
NOT TO SCALE

CLEAN-OUT DETAIL
NOT TO SCALE

18"

1/2"

1/2"

4"

CAST IRON VALVE BOX

ADJUSTABLE

1 - VALVE BOX AND BOOT SHALL BE CAST IRON.

2 - VALVE COVER SHALL BE MARKED "WATER".

3 - VALVE TOP SHALL BE FLUSH WITH FINISHED GRADE OF NATURAL GROUND.

4 - GATE VALVE SHALL BE RESILIENT SEATED VALVE WITH RING-TITE ENDS OR APPROVED EQUAL.

5 - EARTH UNDER FLANGE TO BE FIRM AND WELL TAMPED TO INSURE AGAINST VALVE BOX SETTING.

WATER MAIN (C-900 or DR-25)

CONCRETE PAD OR BAG OF SAKRETE

TYPICAL VALVE & BOX INSTALLATION

NOT TO SCALE

TYPICAL SIDEWALK
NOT TO SCALE

SEE ARCHITECTURAL PLANS TO COORDINATE DOWNSPOUT SIZE AND LOCATIONS

DOWNSPOUT CONNECTOR DETAIL
NOT TO SCALE

Diagram illustrating the Flexible Pipe Bedding method. The diagram shows a cross-section of a trench with a pipe installed. The bedding consists of compacted backfill in two layers, with compact granular material at the bottom. The trench is filled with seed and mulch. The pipe is marked with a spring line and a flexible pipe. The bedding is compacted to meet the specifications for tracer wire requirements. The diagram also shows undisturbed soils on either side of the trench.

Labels in the diagram include:

- SEED & MULCH TRENCH ARE
- UNDISTURBED SOILS
- COMPACTED BACKFILL
- MARKING TAPE (SEE SPECS FOR TRACER WIRE REQ'S.)
- FLEXIBLE PIPE
- SPRING LINE OF PIPE
- COMPACT BACKFILL IN TWO LAYERS (AS SHOWN)
- COMPACT GRANULAR MATERIAL
- 4" to 6"

FLEXIBLE PIPE BEDDING

NOT TO SCALE (UNPAVED)

TYPICAL TURNDOWN SIDEWALK
NOT TO SCALE